

St Catherine's Point

Public Footpath NT38 Diversion Order
Route to be Extinguished AB (bold continuous line)
Route to be Created ABCDEFG (bold broken line)

7423
CH

	<p>DIRECTORATE OF CORPORATE & ENVIRONMENT SERVICES</p> <p>ENGINEERING SERVICES JUBILEE STORES, THE QUAY NEWPORT, IW, PO302EH</p> <p>Stephen Matthews Bsc (Hons) C Eng MICE MIHT, Head of Engineering Services</p>	<p>HIGHWAYS ACT 1980 s119</p> <p>PUBLIC FOOTPATH NT38 DIVERSION ORDER St Catherine's Lighthouse, Niton</p> <p>Scale: 1/2500 Based upon (or reproduced from) the OS 1/2500 map with the permission of the Controller of HM Stationary Office Crown copyright reserved. Ordnance Survey Licence: No 076694</p>
--	--	---

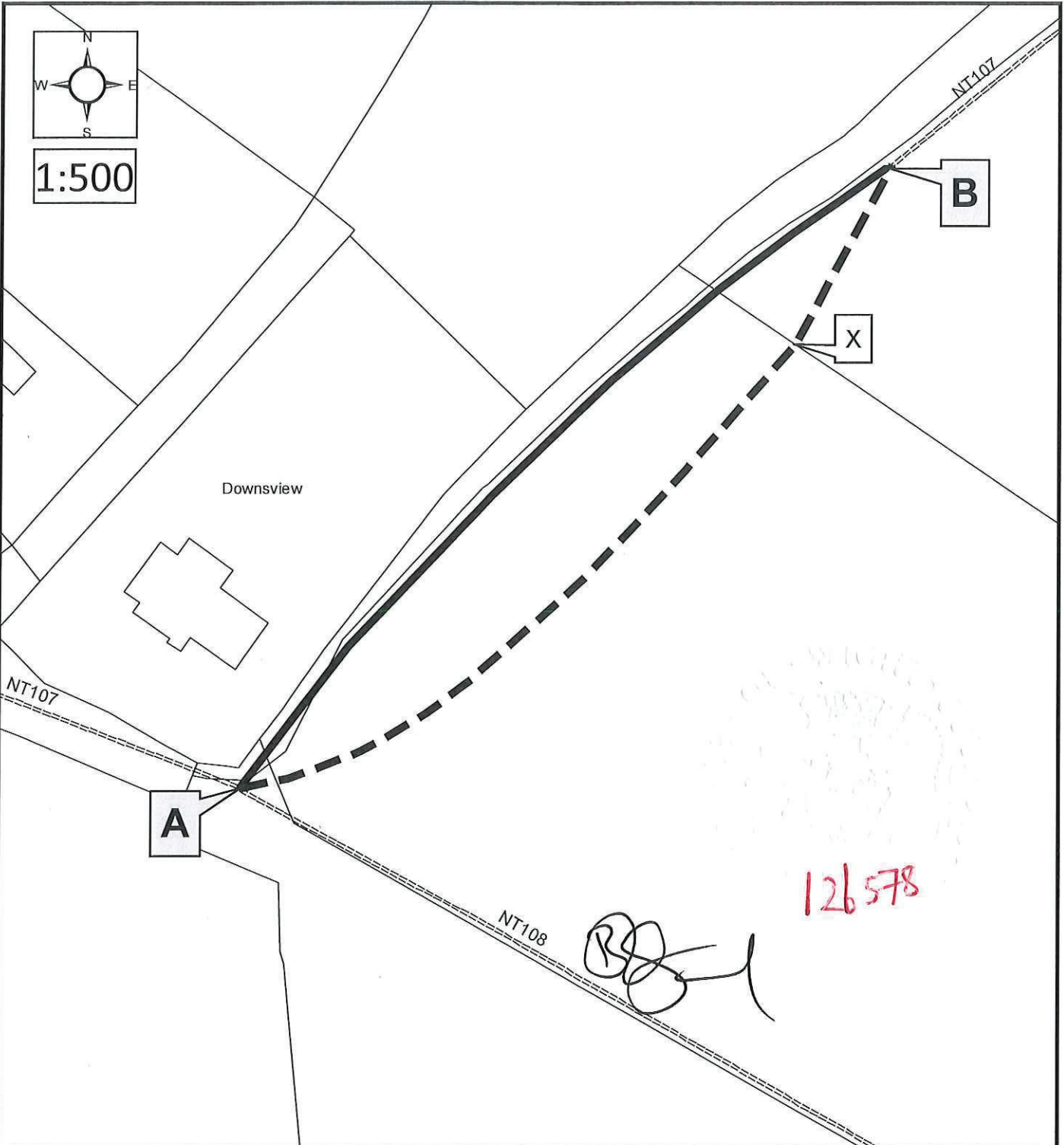

Section of Public Footpath NT107 to be deleted = bold black continuous line A-B
Section of Public Footpath NT107 to be created = bold black dashed line A-B

© Crown copyright and database rights 2018 Ordnance Survey Licence No. 100019229.



ISLE OF WIGHT COUNCIL
 Wendy Perera, Head of Place
 Directorate of Place
 County Hall
 High Street
 Newport
 Isle of Wight
 PO30 1UD

HIGHWAYS ACT 1980 s119
ISLE OF WIGHT COUNCIL
PUBLIC FOOTPATH NT107
(PART) BIERLEY NITON
VENTNOR ISLE OF WIGHT
DIVERSION ORDER
NO. 1 2018