

Section of Public Footpath NC1 to be extinguished: AB (bold continuous line)
Section of Public Footpath NC1 to be created: AB (bold dashed line)

© Crown copyright and database rights 2015 Ordnance Survey Licence No. 100019229.



ISLE OF WIGHT COUNCIL
Alex Minns, Strategic Manager,
Recreation, Leisure & Public Spaces
County Hall
High Street
Newport
Isle of Wight, PO30 1UD

Town & Country Planning Act 1990

ISLE OF WIGHT COUNCIL PUBLIC
FOOTPATH NC1 MERSLEY
GARDENS NEWCHURCH
ISLE OF WIGHT DIVERSION
ORDER NO. 1 2015

**Bold Black Dashed Line =
Public Footpath NC30a to be dedicated as Public Bridleway**

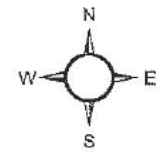

1:2,500

Pond

A

B

Pit

Apsecastle

Wood

FF



66 4m

EXISTING ROUTE SHOWN WITH BOLD CONTINUOUS LINE AB
 NEW ROUTE SHOWN WITH BOLD BROKEN LINE AC

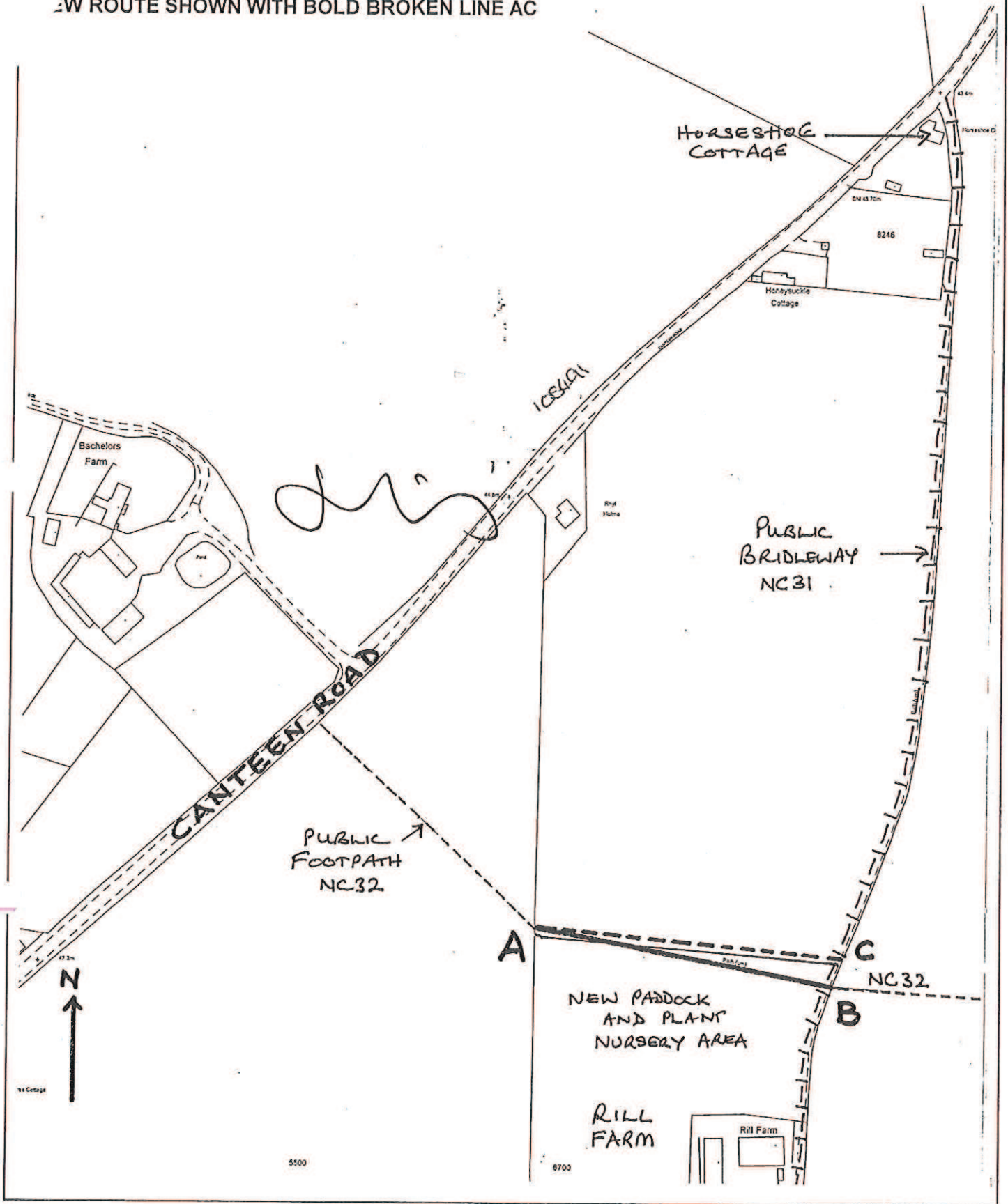

THE ISLE OF WIGHT COUNCIL
 Directorate of Environment and Neighbourhoods
 Director Stuart Love
 Engineering Services
 Enterprise House, St Cross Business Park
 Newport IW, PO30 5WB

Highways Act 1980 s119

Scale 1/2500

**ISLE OF WIGHT COUNCIL PUBLIC FOOTPATH
 PUBLIC FOOTPATH NC32 VENTNOR ISLE OF
 WIGHT DIVERSION ORDER NO 1 2008**

Based upon (or reproduced from) the OS digital mapping with the permission of the Controller of HM Stationary. Office Crown copyright reserved. Ordnance Survey Licence: No 100019229.2008

Public Bridleway Creation Order
 Route to be Created C-B-D (bold broken line)

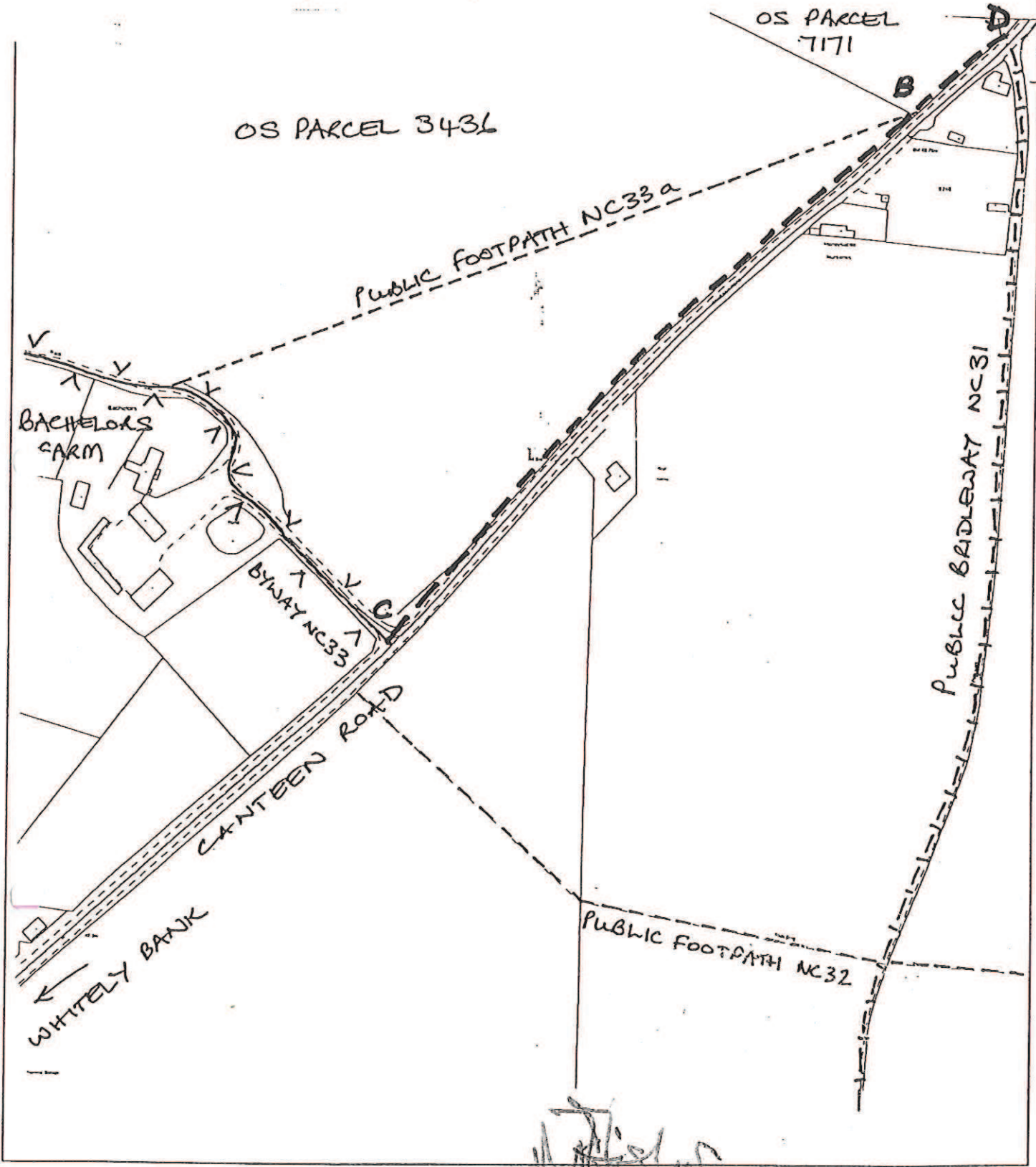

Handwritten signature

Handwritten initials



DIRECTORATE OF CORPORATE AND ENVIRONMENT SERVICES
 ENGINEERING SERVICES
 JUBILEE STORES, NEWPORT
 ISLE OF WIGHT, PO30 2EH
 Telephone : (01983) 825777
 Stephen Matthews Bsc (Hons) C Eng MICE MIHT
 Head of Engineering Services

HIGHWAYS ACT 1980 s26
PUBLIC BRIDLEWAY CREATION ORDER
 Bachelors Farm, Canteen Road, Whitely Bank
 Scale: 1/2500
 Based upon (or reproduced from) the OS 1/2500 map with the permission of the Controller of HM Stationary Office
 Crown copyright reserved. Ordnance Survey Licence: No 076694

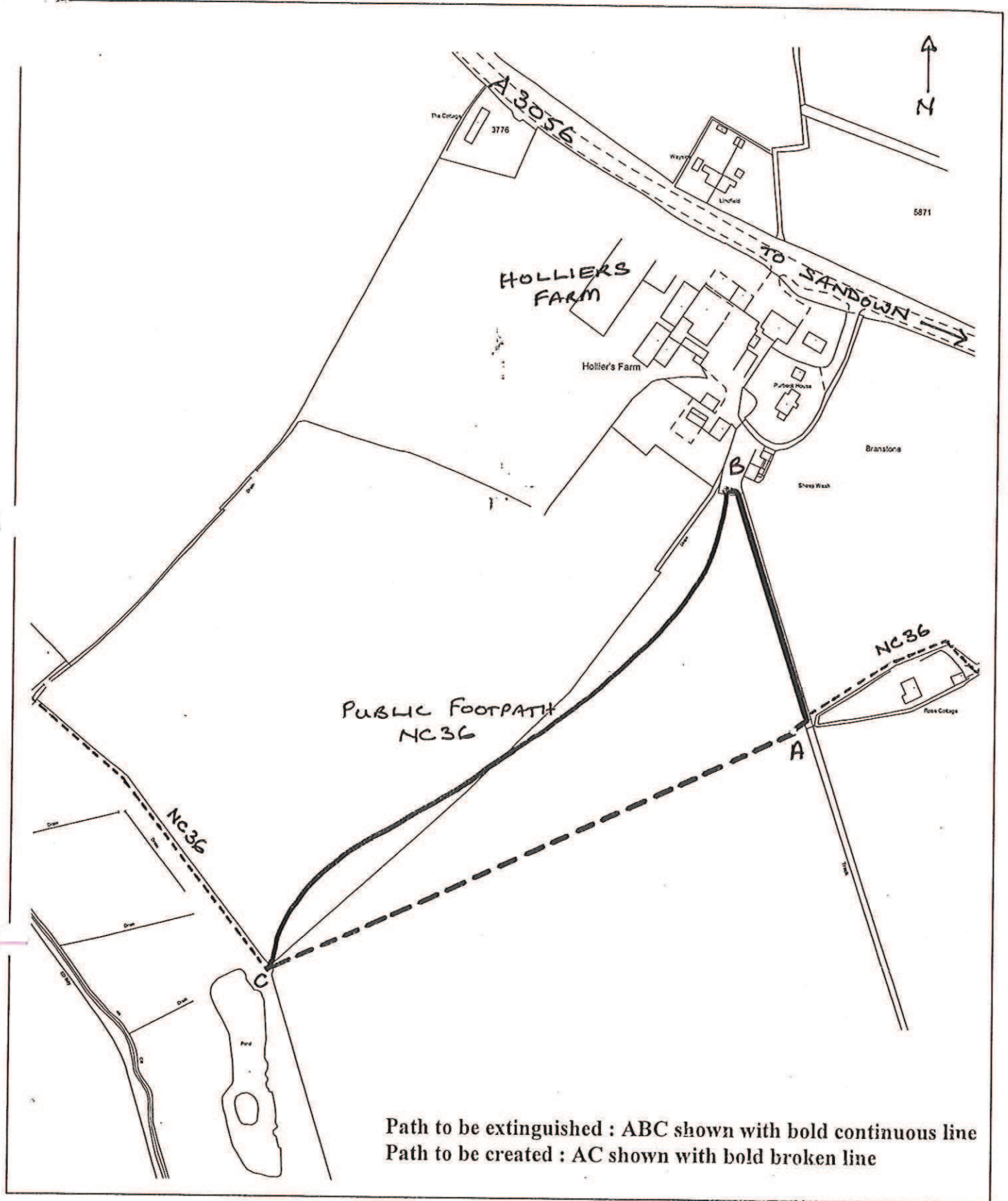

Path to be extinguished : ABC shown with bold continuous line
 Path to be created : AC shown with bold broken line



THE ISLE OF WIGHT COUNCIL
 Directorate of Economic Development and
 Regeneration

 Stephen Matthews Bsc (Hons) C Eng MICE
 MIHT
 Head of Engineering Services
 Enterprise House, St Cross Business Park
 Newport IW, PO30 5WB

Highways Act 1980 s119
 ISLE OF WIGHT COUNCIL PUBLIC FOOTPATH
 NC36 HOLLIERS FARM BRANSTONE ISLE OF
 WIGHT DIVERSION ORDER No 1 2006
 Scale 1/2500
 Based upon (or reproduced from) the OS Masterrmap with the
 permission of the Controller of HM Stationary Office Crown
 copyright reserved. Ordnance Survey Licence: No 076694

1012/15

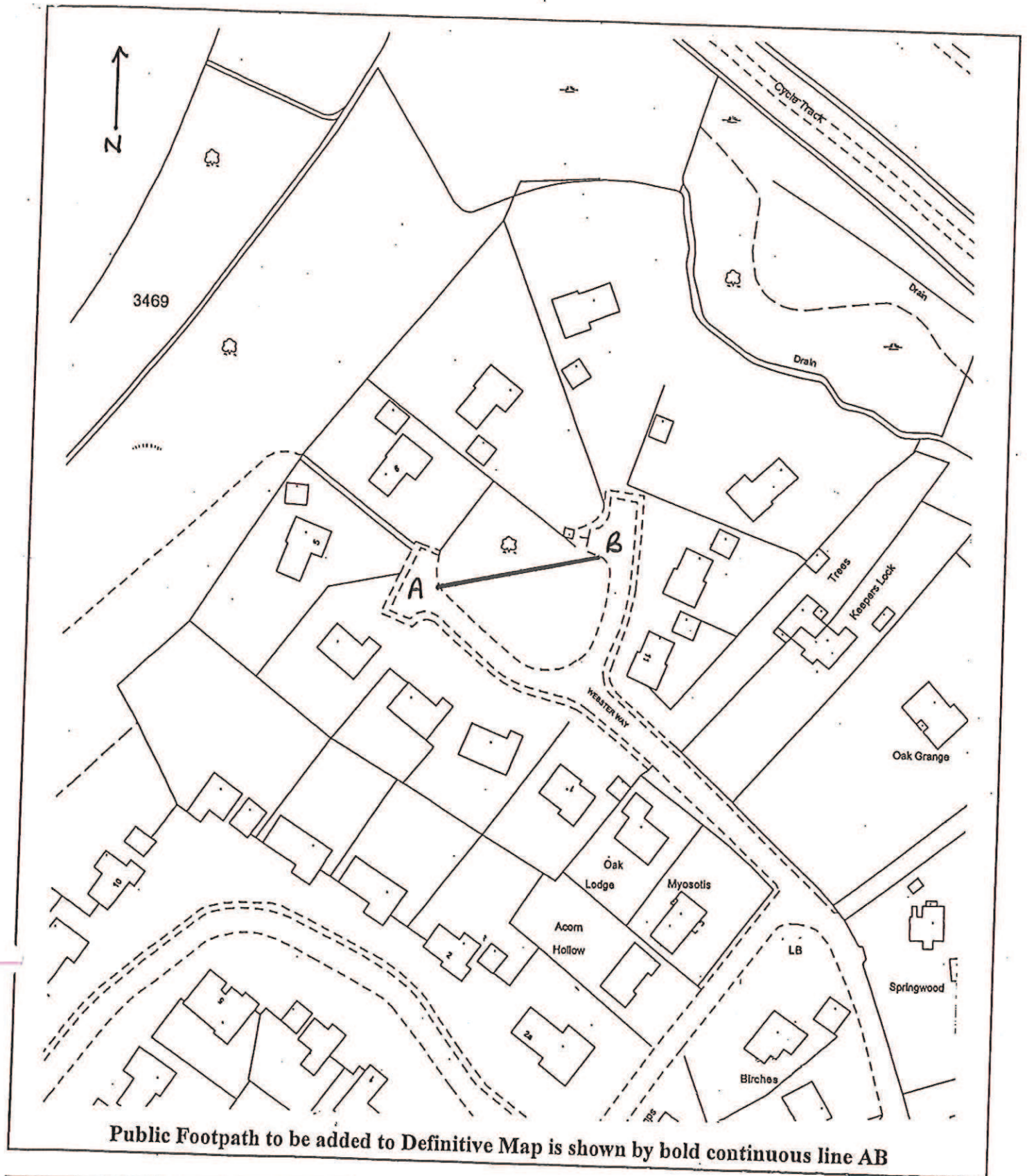

Public Footpath to be added to Definitive Map is shown by bold continuous line AB



Wildlife & Countryside Act 1981 s53 Scale 1/1250
DEFINITIVE MAP MODIFICATION ORDER
Public Footpath
Alverstone Garden Village

Based upon (or reproduced from) the OS Landline digital mapping with the permission of the Controller of HM Stationary Office Crown copyright reserved. Ordnance Survey Licence: No 076694

Authorised Signatory
Isle of Wight Council
 Surveying Authority

102643

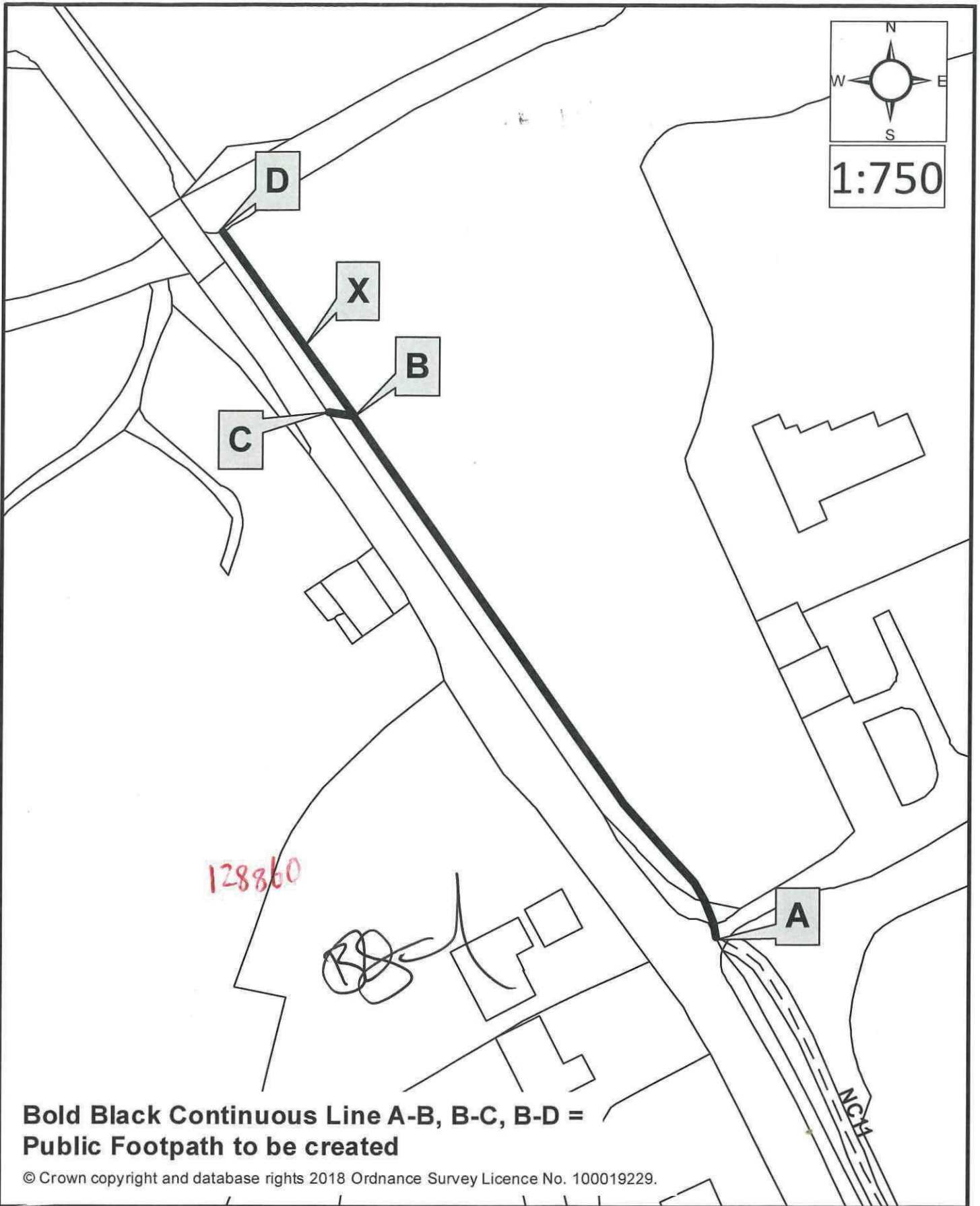

**Bold Black Continuous Line A-B, B-C, B-D =
Public Footpath to be created**

© Crown copyright and database rights 2018 Ordnance Survey Licence No. 100019229.

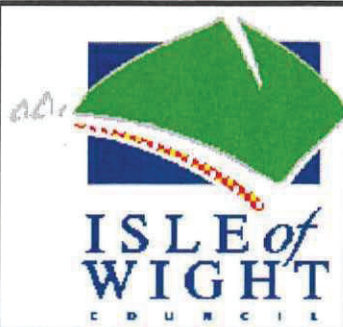

ISLE OF WIGHT COUNCIL
Alex Minns
Head of Commercial Services
Directorate of Neighbourhoods
County Hall
High Street
Newport
Isle of Wight
PO30 1UD

Highways Act 1980, Section 26

ISLE OF WIGHT COUNCIL PUBLIC
FOOTPATH NC54 PARSONAGE FARM
NEWCHURCH ISLE OF WIGHT
CREATION ORDER NO. 1 2019