

**ISLE OF WIGHT COUNCIL - HIGHWAYS PFI**

**SCHEDULE 19 – LAND/PLANS**

## **SCHEDULE 19**

### **Land/Plans**

The plans for the Principal Depot, Stag Lane Lane Depot and the Smallbrook Depot are contained in the DVD attachment to this Schedule.

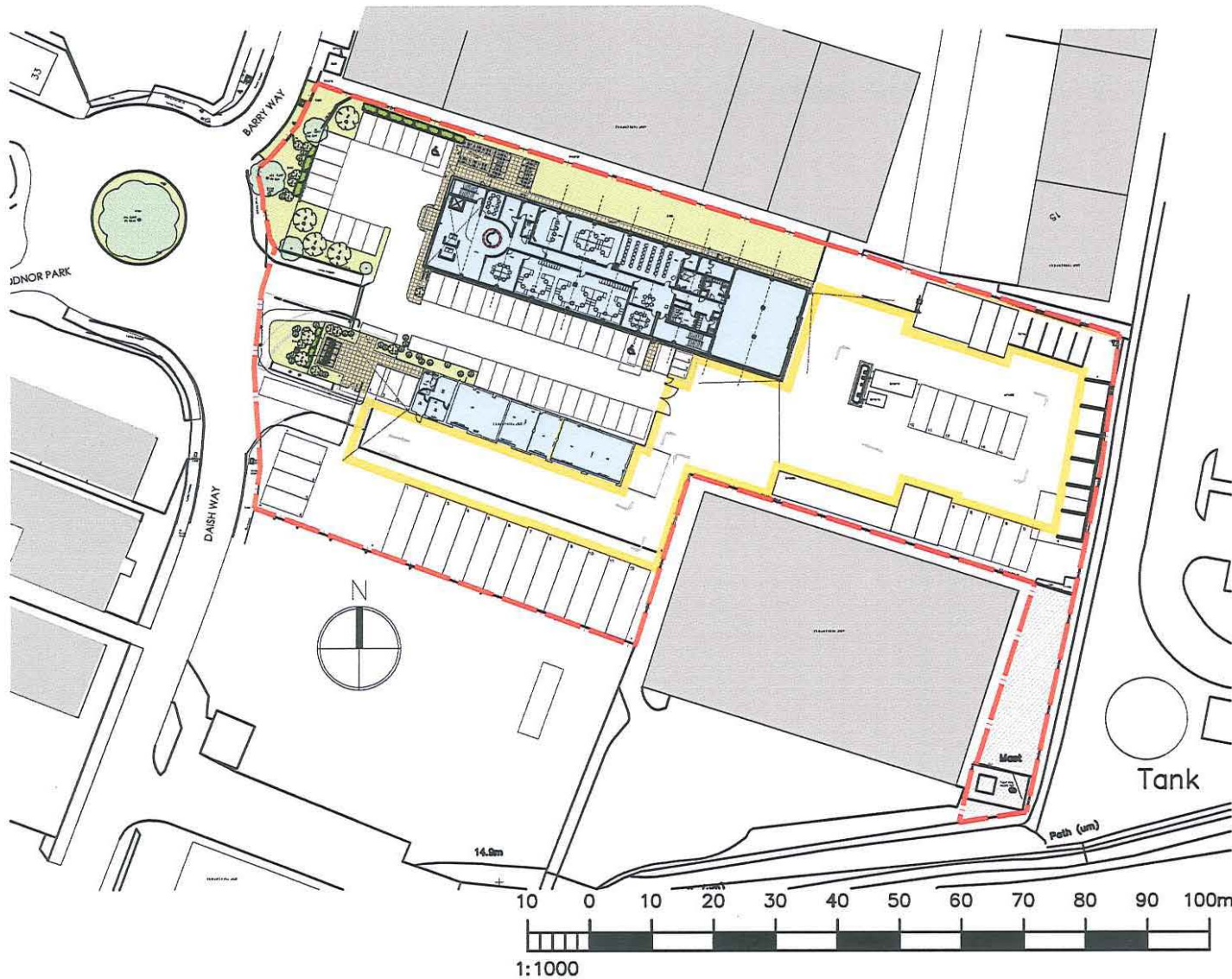

Notes

1. This drawing is the copyright of MH Architects Ltd
2. Do not scale this drawing except for Local Authority planning purposes
3. All dimensions must be checked on site by the contractor prior to commencement of the works.



Rev.	Revision	By	Date	Check	Date
A	North Point added to Drawing.		21/09/12		

Red Boundary Line: 8115 square metres



Part of Depot ownership occupied by communications mast

# Office Building Refurbishment

& Depot Site Extended & Remodelled  
 Daish Way, Newport, Isle of Wight  
 Euorvia Group Limited

Project & Drawing title  
**Combined Site Plan & Extended Boundary**

Drawn	Date	Checked	Date	Scale at A4	
KHM	00/00/00		21/09/12	1:1000	
Job N°	11 100	Drawing N°	PR 13	Rev.	A
Status	<b>PRELIMINARY DRAWING</b>				

Ground Floor / Bicentennial Building  
 Southern Gate / Chichester  
 West Sussex / PO19 8EZ

t. 01243 774748  
 e. admin@mharchitects.co.uk  
 www.mharchitects.co.uk

Limited Company  
 Registered in England No. 0994337



Land Registry  
Official copy of  
title plan

Title number IW20211  
Ordnance Survey map reference SZ4990SE  
Scale 1:1250  
Administrative area ISLE OF WIGHT



© Crown Copyright. Produced by Land Registry. Reproduction in whole or in part is prohibited without the prior written permission of Ordnance Survey. Licence Number 100026316.





# Land at Smallbrook Stadium, Ashley Road, Ryde, PO33 4BH

PDR69094/RC  
July 2012

1:2,500

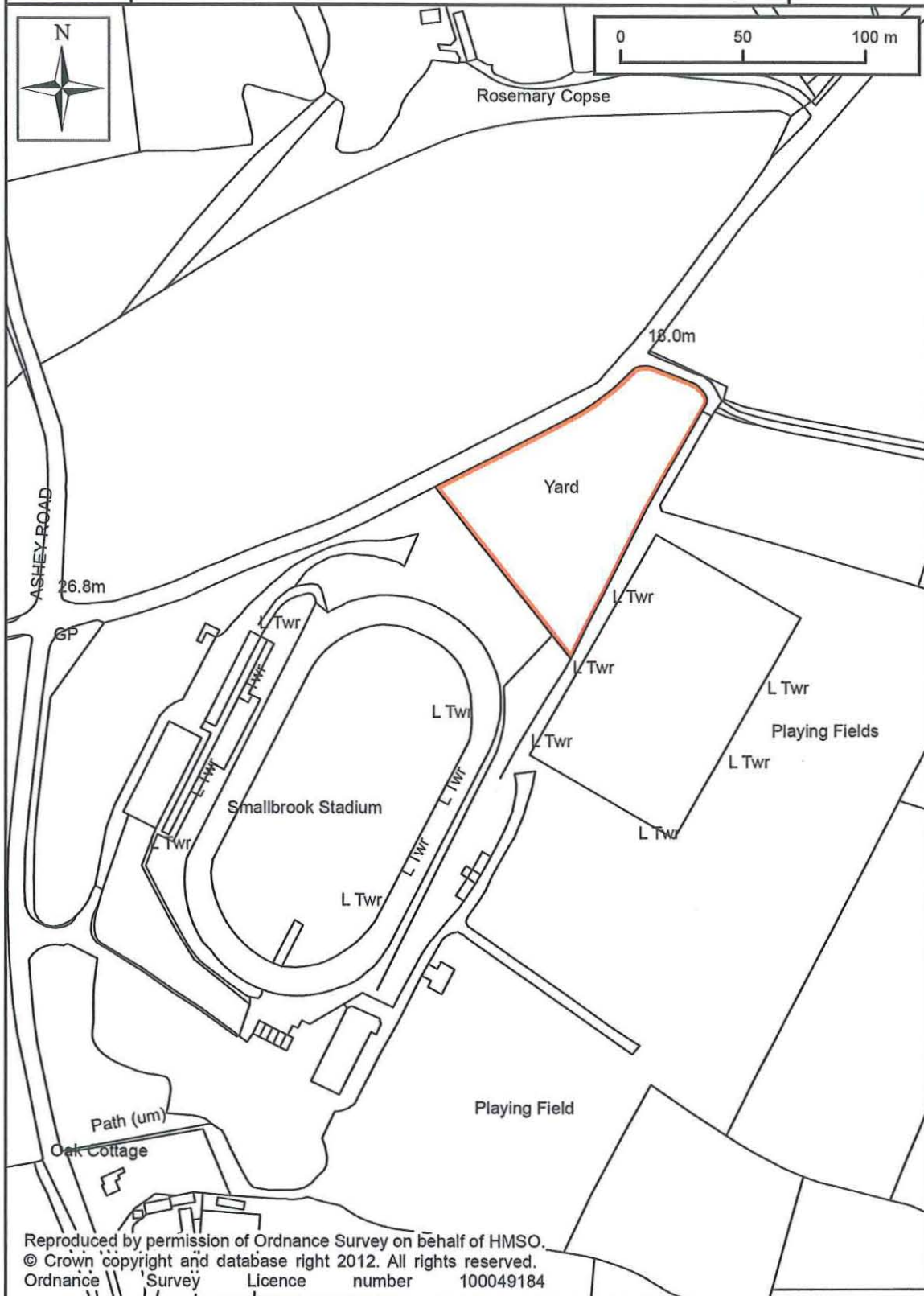
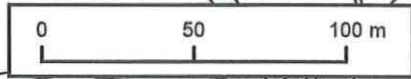

Reproduced by permission of Ordnance Survey on behalf of HMSO.  
© Crown copyright and database right 2012. All rights reserved.  
Ordnance Survey Licence number 100049184



