

What to do with your Christmas waste



Pop the following items in your recycling bin or green gull sack



Biscuit/cake tins and plastic tubs

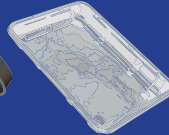

Clean food packaging



Empty drinks cans



Empty glass and plastic bottles and jars



Empty aerosols and shower gel/shampoo bottles

Place your paper and card in your insert or blue gull proof sack

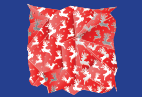

Non-metallic wrapping paper



Empty cardboard boxes



Newspapers and magazines



Christmas cards (no glitter or decorations)

You can bundle excess cardboard or place any excess paper or card, including shredded paper, in a clear or white sack and leave to the side of your bin or gull proof sack

Pop the following items in your food caddy



Turkey and meat scraps



Vegetables



Teabags and coffee grounds



Christmas sweet treats



Small bones



Cheese and biscuits

Pop the following items in your black bin or black gull sack



Glittery cards and foil based/glittery wrapping paper



Tinsel, metallic foil crackers and broken decorations

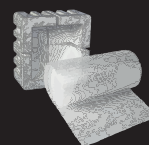

Polystyrene, cling film and bubblewrap

Take to Lynnbottom/Afton Marsh recycling centres



Ensure you put your black bin bags in your black bin



Batteries



Candles



Bulbs and lights

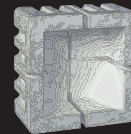

Polystyrene



Electronics