

Public Footpath A14 Diversion Order
Route to be Extinguished ABC (bold continuous line)
Route to be Created AB (bold broken line)

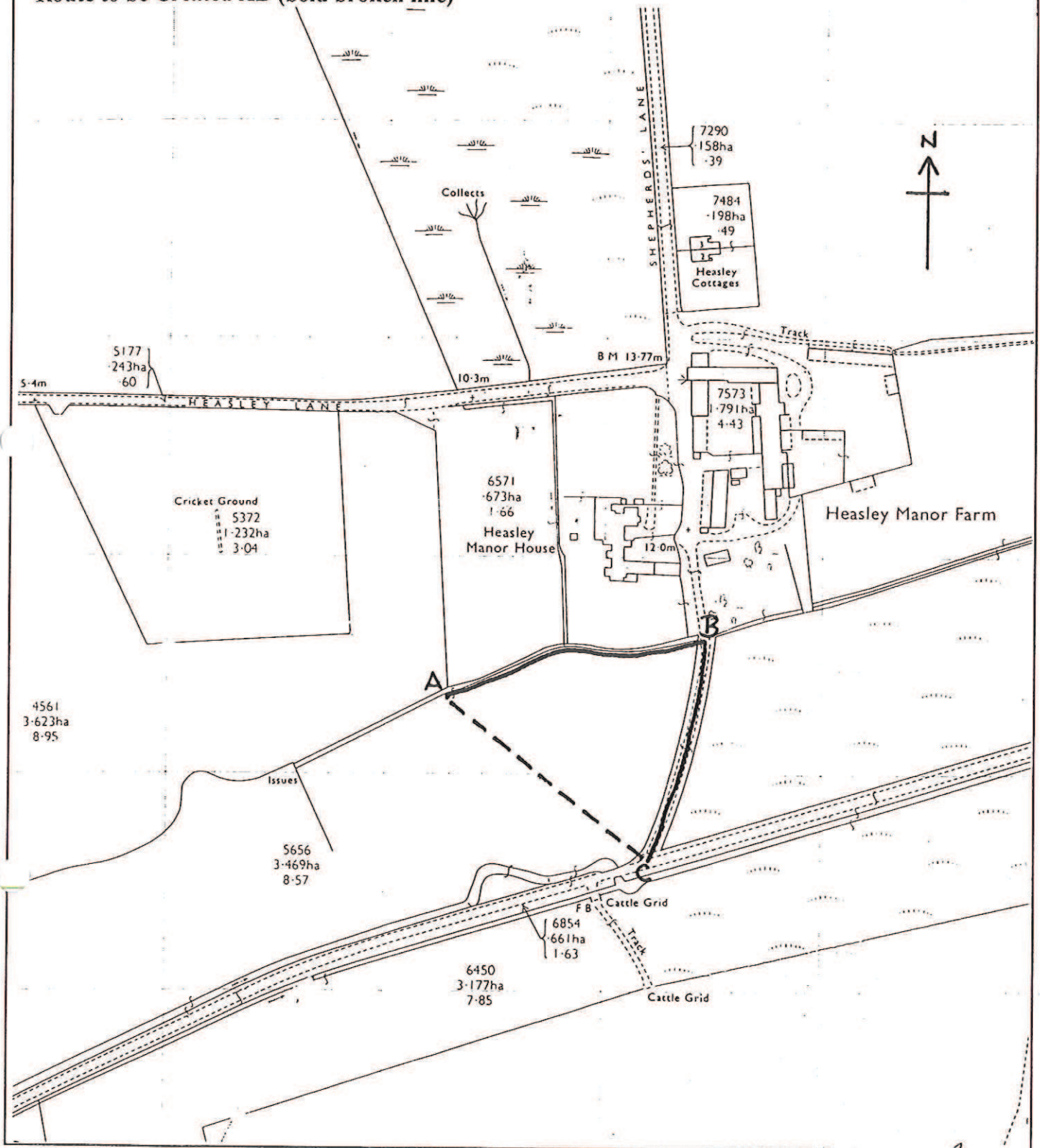

DIRECTORATE OF CORPORATE AND ENVIRONMENT SERVICES
 ENGINEERING SERVICES
 JUBILEE STORES, NEWPORT
 ISLE OF WIGHT, PO30 2EH
 Telephone: (01983) 825777
 Stephen Matthews Bsc (Hons) C Eng MICE MIHT
 Head of Engineering Services

TOWN & COUNTRY PLANNING ACT 1990 s257
PUBLIC FOOTPATH A14 DIVERSION ORDER
 Haseley Manor, Arreton
 Scale: 1/2500
 Based upon (or reproduced from) the OS 1/2500 map with the permission of the Controller of HM Stationary Office
 Crown copyright reserved. Ordnance Survey Licence: No 076694

BRIDLEWAY CREATION ORDER
HEASLEY, ARRETON

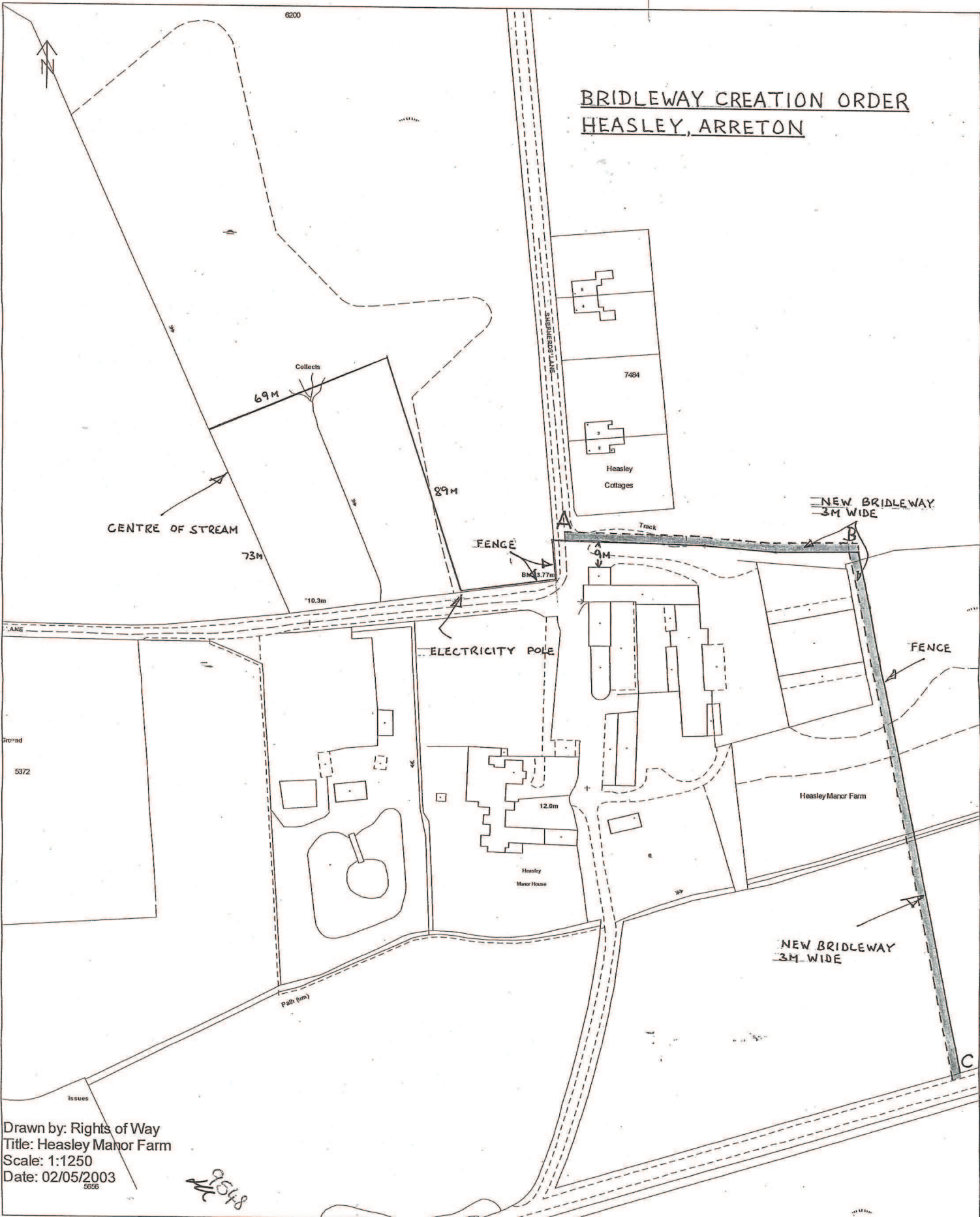

Drawn by: Rights of Way
 Title: Heasley Manor Farm
 Scale: 1:1250
 Date: 02/05/2003

91548

This map is reproduced from Ordnance Survey material with the permission of Ordnance Survey on behalf of Her Majesty's Stationery Office (C) Crown copyright. Unauthorised reproduction infringes Crown copyright and may lead to prosecution or civil proceedings.

109385

Downend Road

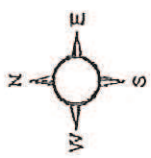

Arreton Barns
Craft Village

Arreton Cross

A3056

B

A

GP

Public Footpath to be created ABC



THE ISLE OF WIGHT COUNCIL
Directorate of Environment and Neighbourhoods
Director Stuart Love
Engineering Services
Enterprise House, St Cross Business Park
Newport IW, PO30 5WB

Highways Act 1980 s25 Scale 1/1250
ISLE OF WIGHT COUNCIL PUBLIC FOOTPATH
CREATION AGREEMENT - ARRETON BARNES
Based upon (or reproduced from) the OS digital mapping with the
permission of the Controller of HM Stationary Office Crown
copyright reserved. Ordnance Survey Licence: No 100019229.2008

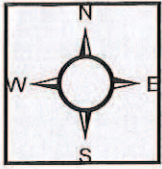

1:2,500

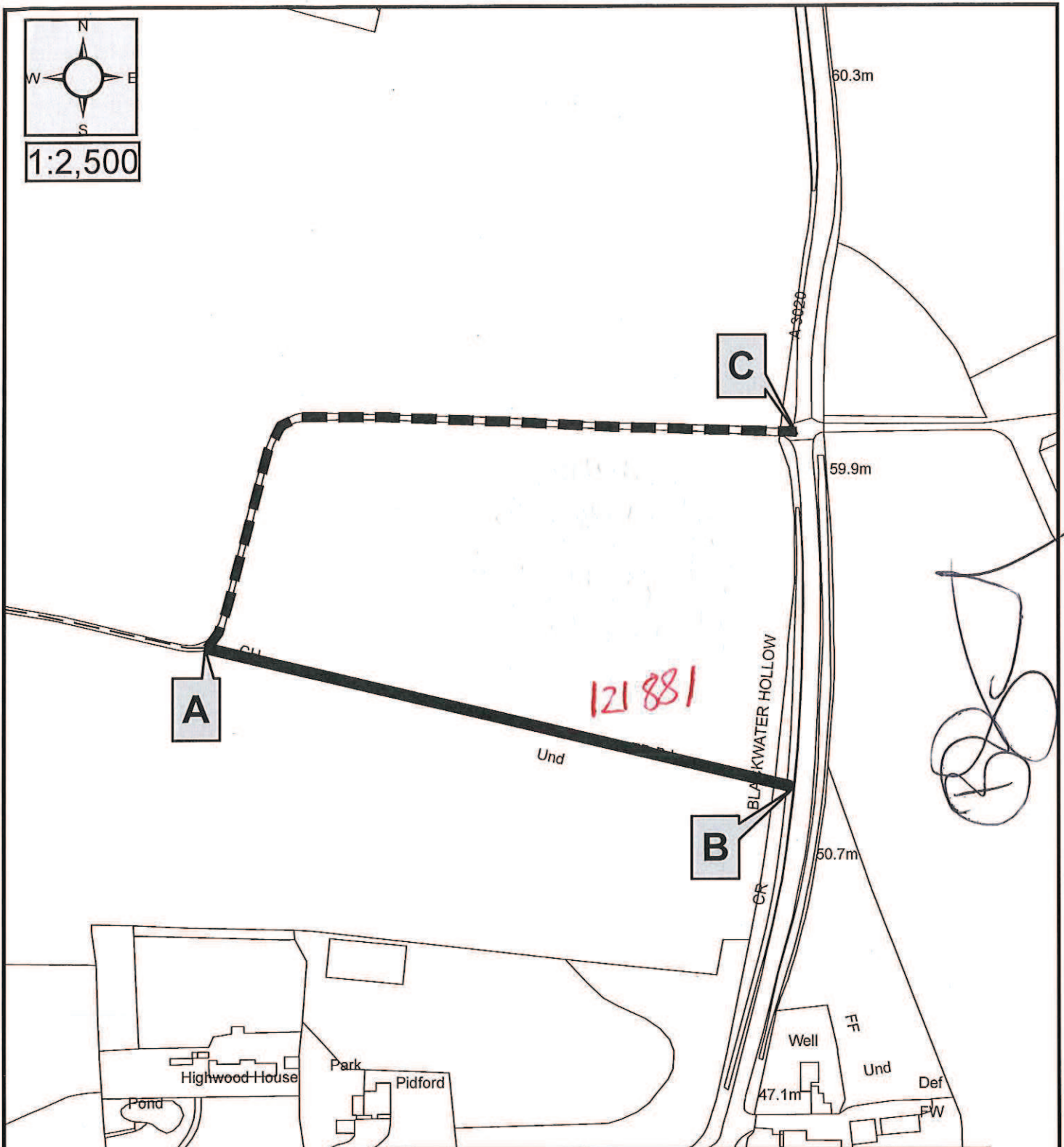

Bold Black Continuous Line A-B = Section of Public Bridleway A41 to be deleted
Bold Black Dashed Line A-C = Section of Public Bridleway A41 to be created

© Crown copyright and database rights 2016 Ordnance Survey Licence No. 100019229.



ISLE OF WIGHT COUNCIL
 Alex Minns
 Head of Commercial Services
 Directorate of Place
 County Hall
 High Street
 Newport
 Isle of Wight
 PO30 1UD

Highways Act 1980 s119

**ISLE OF WIGHT COUNCIL PUBLIC
 BRIDLEWAY A41 (PART) PIDFORD
 ROOKLEY ISLE OF WIGHT
 DIVERSION ORDER NO. 1 2016**

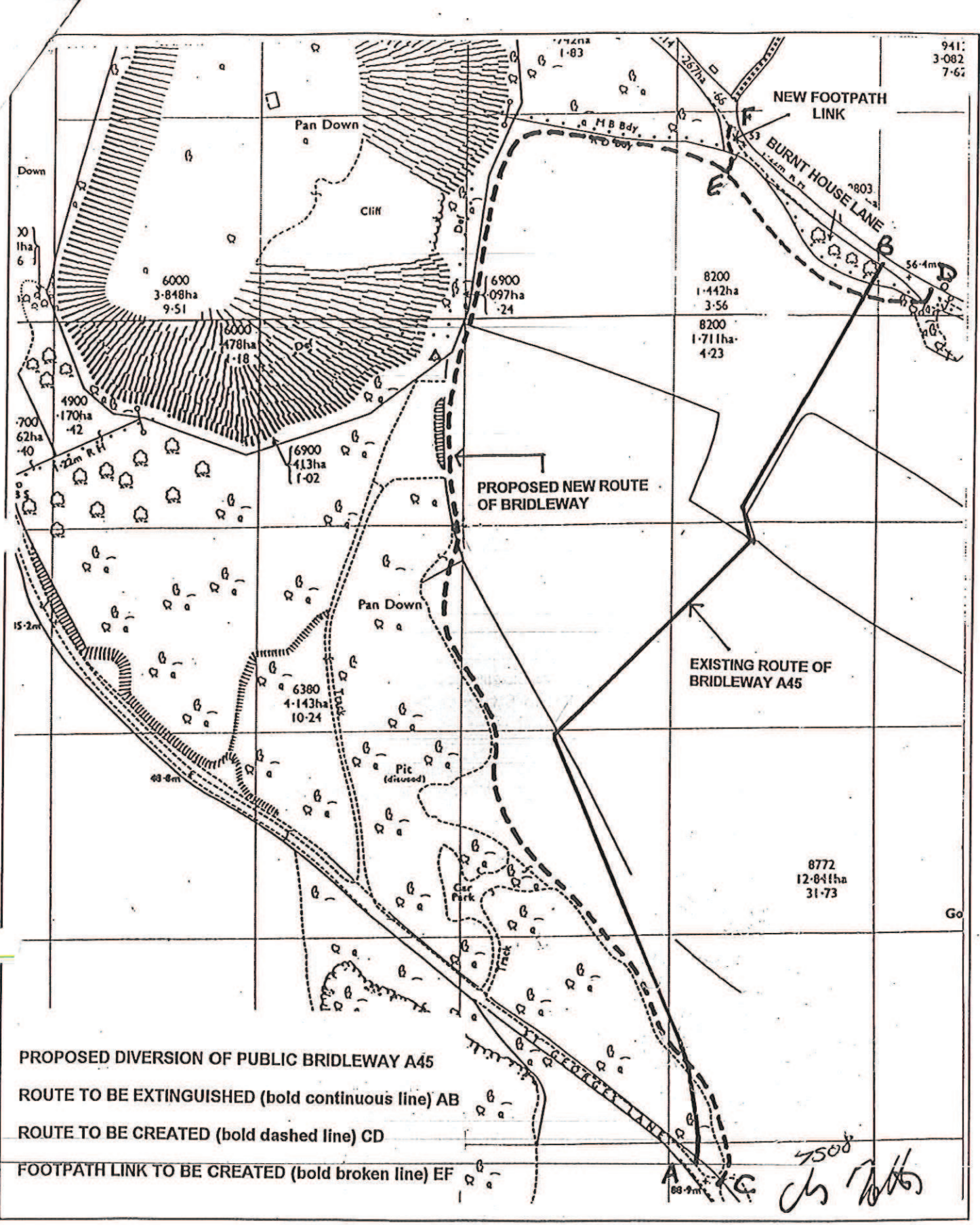

PROPOSED DIVERSION OF PUBLIC BRIDLEWAY A45
ROUTE TO BE EXTINGUISHED (bold continuous line) AB
ROUTE TO BE CREATED (bold dashed line) CD
FOOTPATH LINK TO BE CREATED (bold broken line) EF

4500
 A
 68.9m
 K.C.
 J.S.
 T.H.



DIRECTORATE OF ENVIRONMENT SERVICES Director: David Jagger LLB
HIGHWAYS & TRANSPORTATION
 COUNTY HALL, NEWPORT
 ISLE OF WIGHT, PO30 1UD
 Telephone : (01983) 821000
 Stephen Matthews Bsc(Hons) C Eng MICE MIHT
 Head of Highways and Transportation

TOWN & COUNTRY PLANNING ACT 1990
PUBLIC BRIDLEWAY A45 DIVERSION ORDER
and CREATION OF PUBLIC FOOTPATH LINK
 St George's Down, Newport
 Scale: 1/2500
 Based upon (or reproduced from) the OS 1/2500 map with the permission of the Controller of HM Stationary Office
 Crown copyright reserved. Ordnance Survey Licence: No 076694

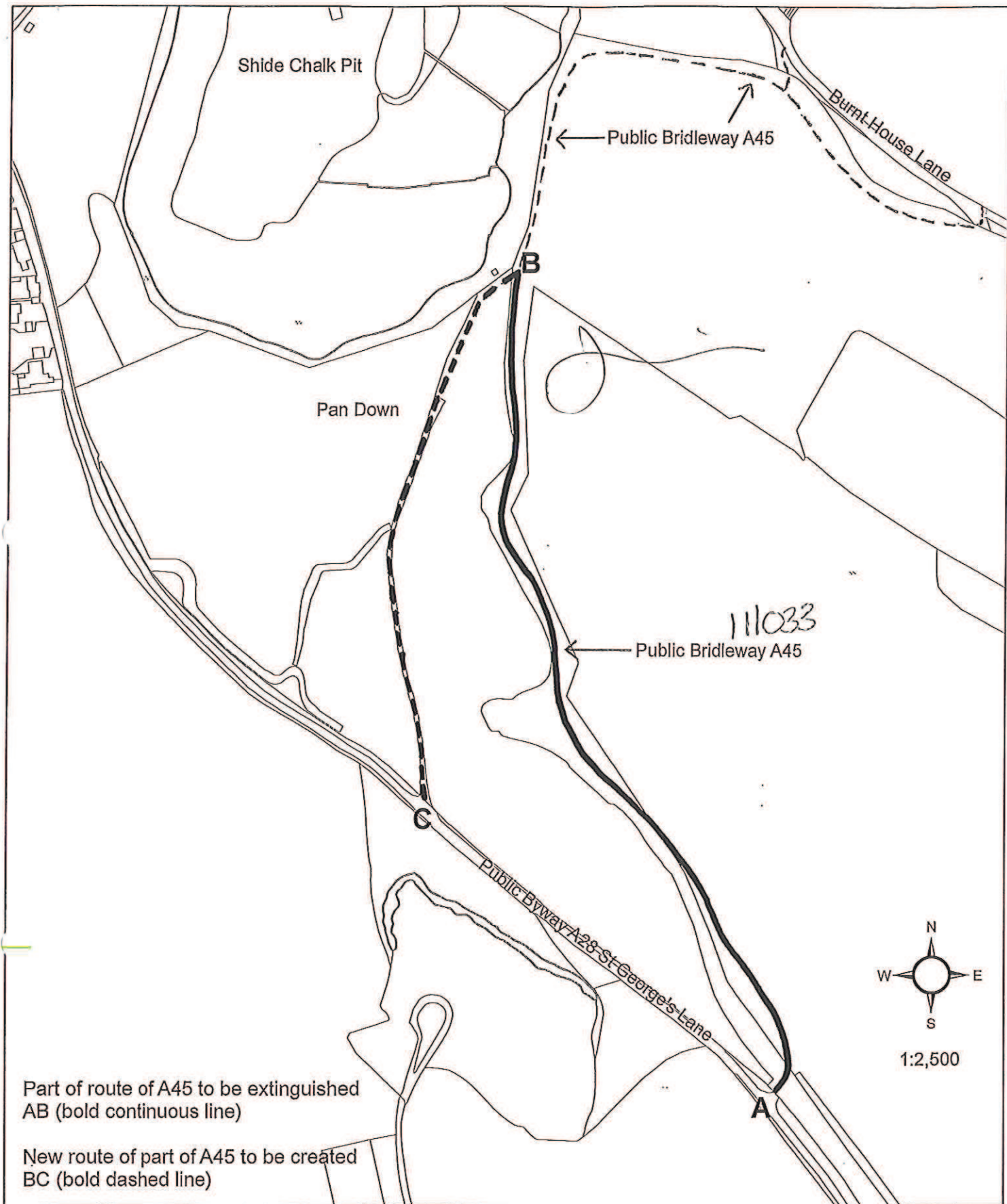

THE ISLE OF WIGHT COUNCIL
 Directorate of Economy and Environment
 Director Stuart Love
 Engineering Services
 County Hall
 High Street, Newport
 Isle of Wight, PO30 1UD

Town & Country Planning Act 1990 S. 257 & 261
**ISLE OF WIGHT COUNCIL PUBLIC BRIDLEWAY
 A45 ST. GEORGE'S DOWN ARRETON ISLE OF
 WIGHT DIVERSION ORDER NO. 1 2011**
 Based upon (or reproduced from) the OS digital mapping with
 the permission of the Controller of HM Stationary Office
 Crown copyright reserved. Ordnance Survey Licence: No
 100019229.2008

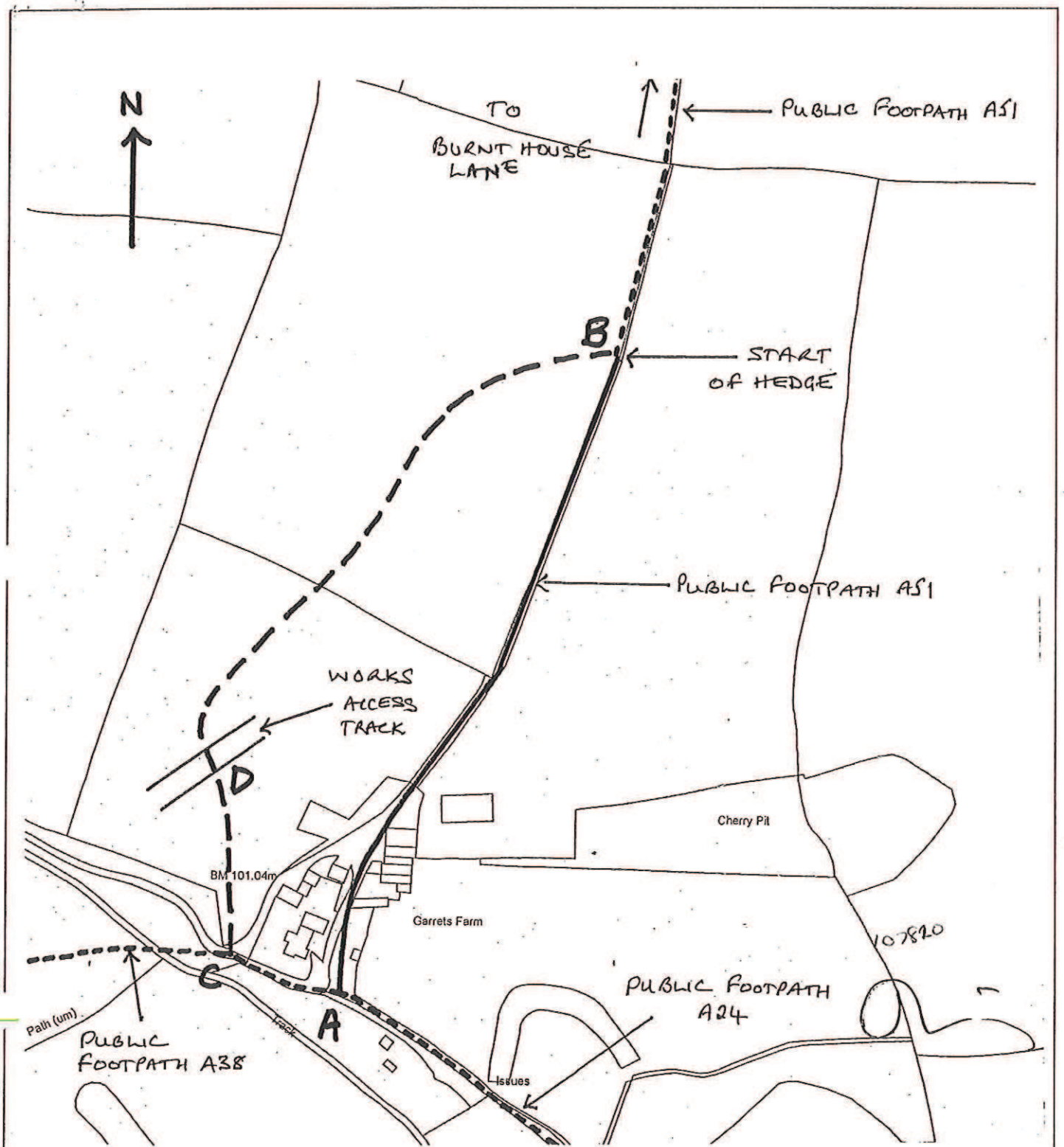

Part of A51 to be diverted during mineral workings then restored shown A-B (bold continuous line)
 Diversion route of A51 for period of mineral workings C-D-B (bold broken line)
 Continuation of N51 and other public footpaths (A38 and A24) shown with short dashed line



THE ISLE OF WIGHT COUNCIL
 Directorate of Economy and Environment
 Director Stuart Love
 Highways & Transport
 Enterprise House, St Cross Business Park
 Newport IW, PO30 5WB

Town & Country Planning Act 1990 Scale 1/2500
 ISLE OF WIGHT COUNCIL PUBLIC FOOTPATH
 N51 GARRETT'S FARM, ST GEORGE'S DOWN,
 ISLE OF WIGHT DIVERSION ORDER No. 1 2010
 Based upon (or reproduced from) the OS digital mapping with the
 permission of the Controller of HM Stationary Office Crown
 copyright reserved. Ordnance Survey Licence: No 100019229.2008



1:2,500

Public Footpath A51

B

125258

Cherry Pit

Garrets Farm

Y

X

(Golf)

Public Footpath A38

Path (um)

C

A

Issues

Public Footpath A24

Ponds

Pond

Golf Course

St George's Down

Path (um)

Section of A51 to be deleted = bold black continuous line A-B
Section of A51 to be created = bold black dashed line C-B

© Crown copyright and database rights 2017 Ordnance Survey Licence No.100019229.



ISLE OF WIGHT COUNCIL
Alex Minns
Head of Commercial Services
Directorate of Place
County Hall
High Street
Newport
Isle of Wight, PO30 1UD

Town & Country Planning Act 1990

ISLE OF WIGHT COUNCIL
PUBLIC FOOTPATH A51 (PART)
GARRETT'S FARM, ST GEORGE'S
DOWN, ISLE OF WIGHT
DIVERSION ORDER NO. 1 2017